

## FLOOR DOOR

Side B	Side C	Side D	VERSION	H LIGHT	H FRAME	FRAME	WINDOW	GLASS	ACCESSORIES
		1 3 4	Standard RAL 7001 *	2000	2100	RAL 7001	Absent		C2
2			Standard RAL 7001 *	2000	2100	RAL 7001	Absent		DMG Lock - C2

C1 = Enabling key for the floor button pad (single insertion) C2 = Enabling key for the floor button pad (double insertion) PM = Button pad on the wall PE = Outside lock and button pad

(\* Doors without holes for handles

Handles to be supplied:

Levels 1, 3 and 4: *Caspim Long*

Level 2: *Caspim Short*

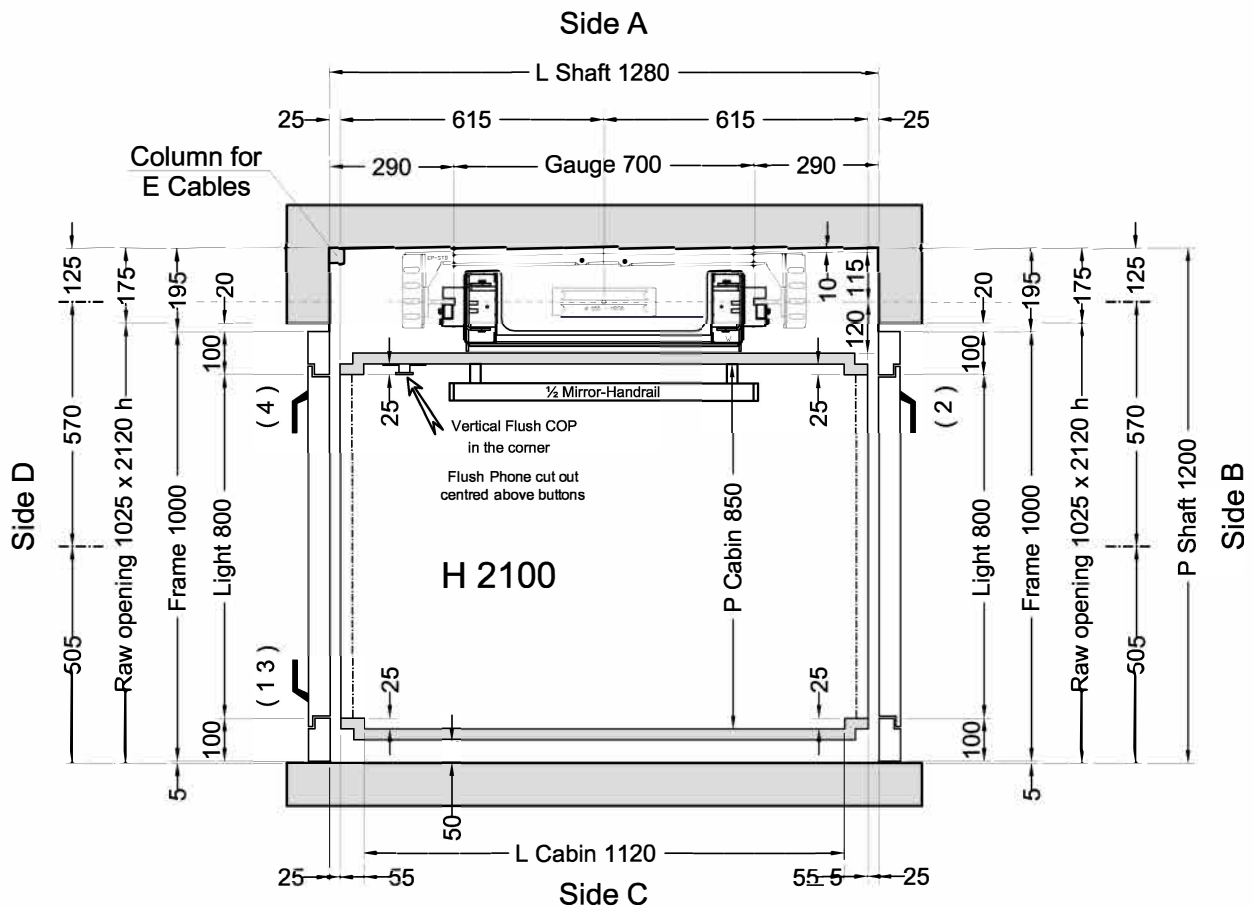

Cabina  
Classica

Feasibility n° 2694 - Wall Side A

**Stops: 4 - Doors: 4**

Shaft in **Reinforced concrete (C.A.)**

Customer own flooring: Dimensions **1180 (L) x 850 (P)** thks **20 mm** Weight: **50 kg**

ORDER	VERSIONS	Description	Designer	Date	Final Drawings	
ORDER NUMBER					Model	SHEET
					ELFO	1/2
		Piano 4 cerniera destra.	L. Del Bianco	01/12/2015		SHEET DIMENS.
		Varie modifiche.	L. Del Bianco	19/11/2015		A3
		CLIENT <b>Lift Shop</b>	Final Drawings L. Del Bianco	1° STESURA 10/12/15		SCALE 1:12.5
		PLACE OF INSTALLATION	CAPACITY	AREA m²	CAPACITY	
			300 kg	0,96		



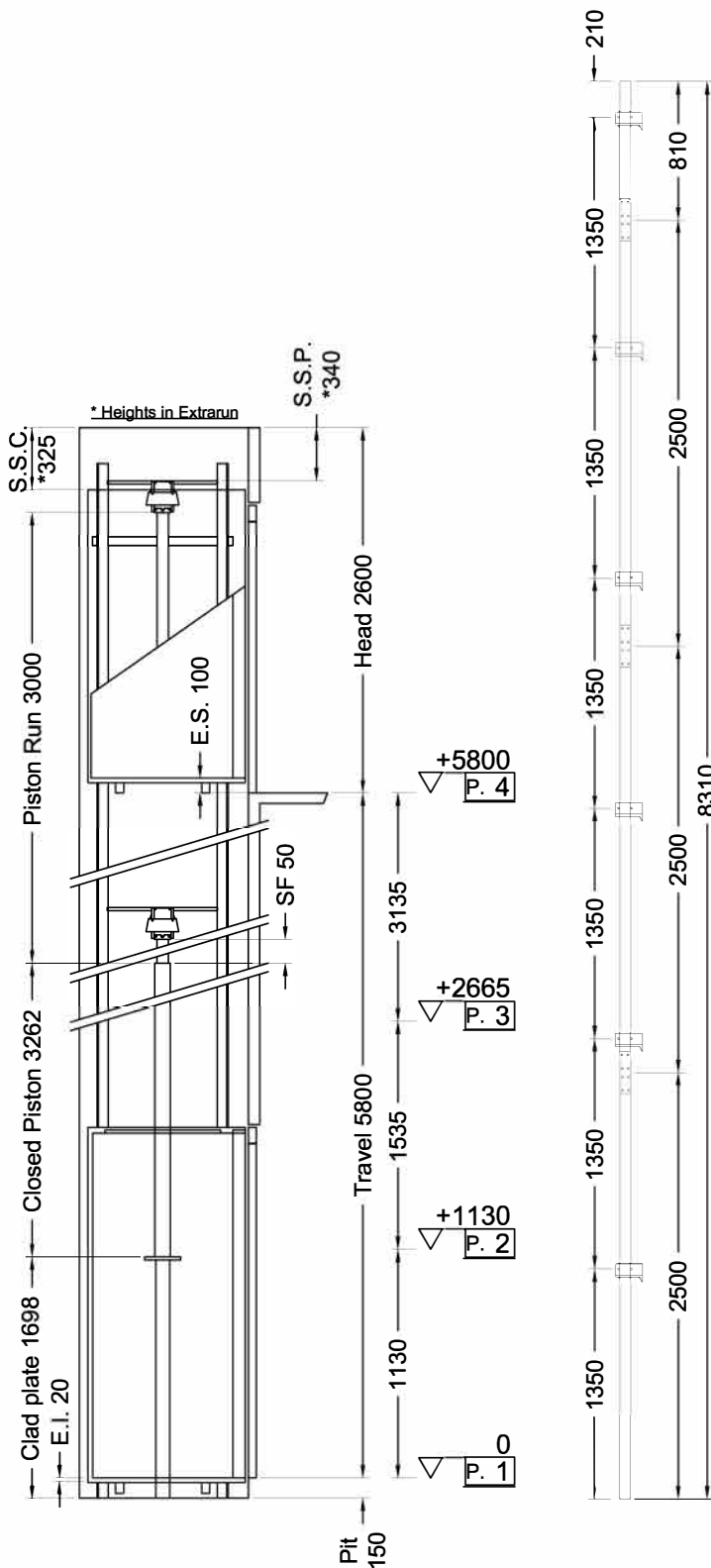

Indirect Installation Speed 0,3 m/s 10/12/15 14.04 (V.2852) <sup>GD</sup>

THRUST DURING NORMAL OPERATION				THRUST OF SAFETY DEVICE INTERVENT.			
P	(N)	9870		P	(N)	579	
N	(N)	792		N	(N)	6792	
F1	(N)	1080		F1	(N)	1800	
F2	(N)	256		F2	(N)	427	

SPACES		PRESSURES		
E.I.	Extrarun below cabin (mm)	20	Max static pressure (bar)	32,95
E.S.	Extrarun above cabin (mm)	100	Min static pressure (bar)	17,66
SF.	Piston extraction (mm)	50	Overpressure limit (bar)	46,13
S.S.P.	Piston/head (mm)	340	Residual pressure (bar)	1,51
S.S.C.	Cabin/head (mm)	315		

HYDRAULIC UNIT		MECHANICAL PARTS	
Central unit	GMV HL 3010 (-*)	Guide rails	70x70x9
Capacity (l/min)	35	Brackets	(Nr) 6
Motor (V)	MF230V	Ropes	Ø 9 mm 6-(1+9+9)
Power (Kw)	2,9	Cables length (mm) 2 x	11000
Nominal current (A)	27	Min actual breaking load (N)	47300
Piston	Start Home (ø)70x5x3000		
Opt. oil position	BASSO		
Tubing	3/4" EN 853 1SN - FD 3/4" - GOMITO 3/4"		
Tubing length (mm)	6000		
Min hydraulic oil (L)	45		

SECURITY DEVICES	Manufacturer	Model	Certificate
Safety Gear	PFB	BP1	TÜV AFV515
Block Valve	START ELEVATOR	1/2" 0327	CA50.00525
Key Locks	Prudhomme	PLT/L/CPX NL 11-400-1002-125-02	

MACHINERY LOCATION			
At floor	1	Length of the hose travel	2000 (mm)
Cables enter in shaft: Side	D		

CABIN		CABIN ACCESSORIES	
Panels	F41PPS	½ Mirror	Side A
Finishes	Inox Scotch Brite	Handrail	Inox S.B., Side A
Oper. panel	Vertical Flush mounted **		
Floor	By Customer		
Ceiling	SPOTS LED - Bianco A32PP		
(**) Corner A/D - Inox Scotch Brite			

OTHER ACCESSORIES	
Enabling key for the cabin button pad, double insertion	
Guides dimension 2.5 m	
Manual pump	
Manostat with overweight signal	
Two speed	
Auto return to Level 3 after adjustable time	
Handles CASPIM (Levels: 1 3 4 Long / Level 2: Short) ←←	
Doors without holes for handles ←←	
Telephone by Lift Shop	
Full height infra-red curtain V2	
Automatic Control 2011	
Call Accept + Emergency manual descent from cabin	
Cut out for flush phone 86 mm x 175 mm centred above buttons on COP	



ORDER  
ORDER NUMBER

CLIENT  
Lift Shop  
PLACE OF INSTALLATION

Final Drawings  
L. Del Bianco  
Final Drawings  
SCALE  
OUT OF SCALE  
1° STESURA  
10/12/15  
SHEET  
2/2